

T5S R66W 2073-28

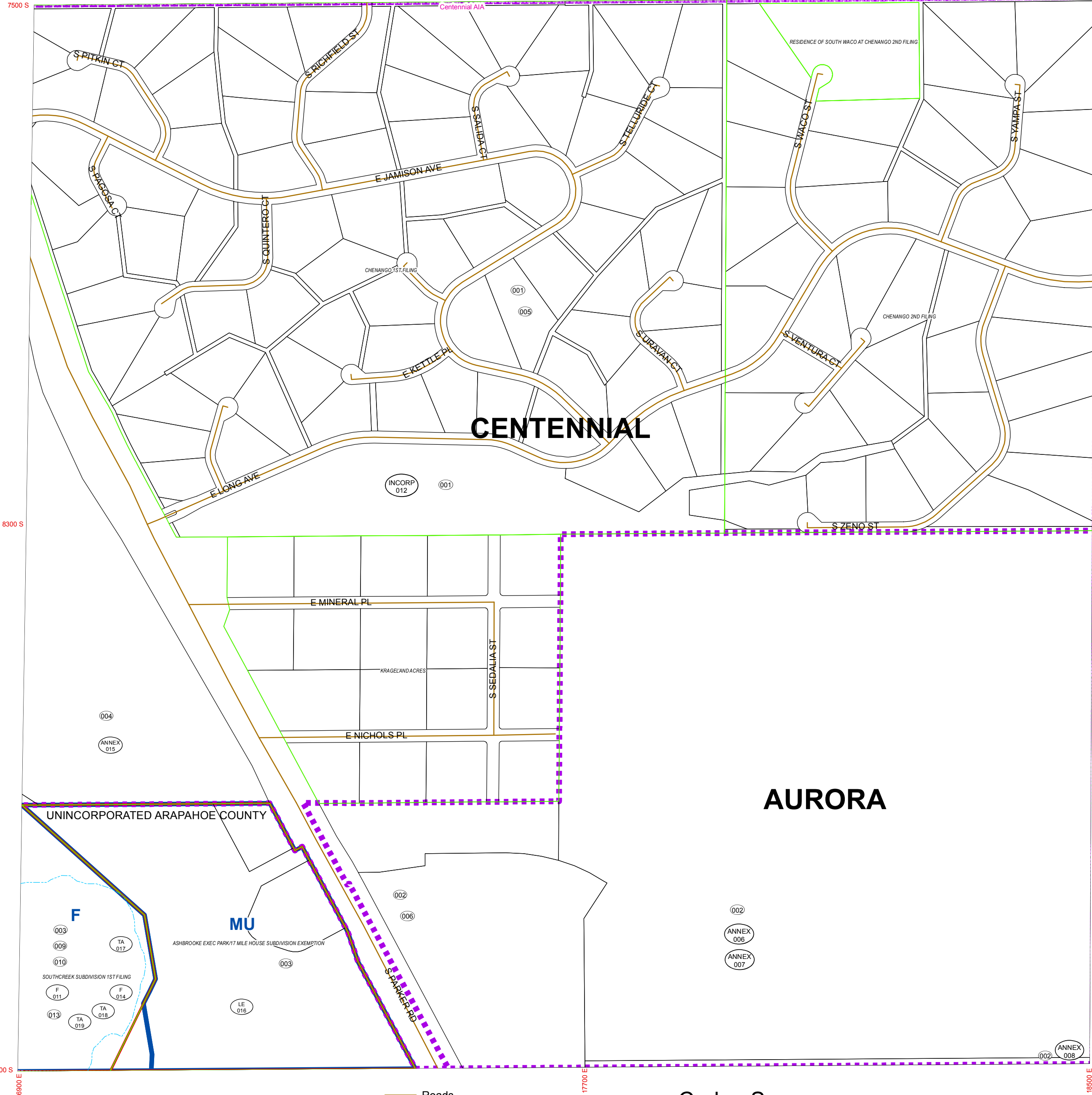

CODE	DATE	CASE	REVISIONS	
			FROM	TO
001	07/25/77	Z77-010	A-1	MU, F
002	12/17/79	Z79-048	A-1	MU, F
003	05/10/83	Z82-046	A-1	MU, F
004	05/16/83	Z82-022	A-1	MU, F
005	08/30/83	A83-026		FDP
006	10/19/87	AO 87-87	MU	AURORA
007	10/19/87	AO 87-88	MU	AURORA
008	05/23/88	AO 88-11	MU	AURORA
009	04/23/99	Z98-010		FDP
010	04/30/99	A98-037		FDP
011	10/12/99	P98-174		FDP
012	02/06/01	CENTENNIAL INCORPORATION		CENTENNIAL
013	08/13/02	Z02-002	MU, F	MU, F
014	08/13/02	P02-009		FDP
015	08/04/06	CO 2006-C-08	MU, F	CENTENNIAL
016	04/26/11	L11-001		LE
017	07/13/11	TA10-009		FDP-TA
018	03/06/14	TA13-007		FDP-TA
019	09/30/14	TA14-009		FDP-TA

**CENTENNIAL**

**AURORA**

UNINCORPORATED ARAPAHOE COUNTY

**F**  
003  
009  
010  
SOUTHCREEK SUBDIVISION 1ST FILING  
F 011  
013  
TA 019

**MU**  
ASHBROOKE EXEC PARK/7 MILE HOUSE SUBDIVISION EXEMPTION  
003  
LE 016

INCORP 012 001

KRAGELAND ACRES

002  
006

002  
ANNEX 006  
ANNEX 007

ANNEX 008

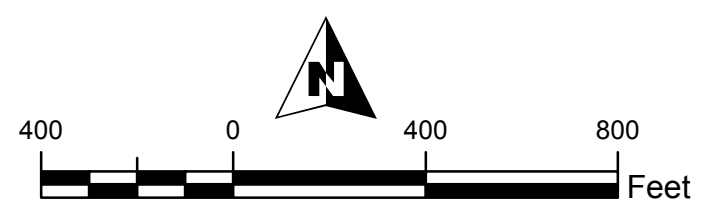

- Roads
- Parcels
- Subdivisions
- FDP/PDP
- Zoning
- Jurisdictions
- Airport Influence Area

Code Sec  
2073 33

Date Saved: 10/1/2014 9:40:01 AM

R68W	R67W	R66W	R65W	R64W	R63W	R62W	R61W	R60W	R59W	R58W	R57W
1971	1973	1975	1977	1979	1981	1983	1985	1987	1989	1991	1993
2077	2075	2073	2071	2069	2067	2065	2063	2061	2059	2057	2055

General Disclaimer:  
Arapahoe County Makes No Representation Or Warranty As To The Accuracy Of This Base Map, And Assumes No Responsibility Or Liability To Any User. This Base Map Is Not A Legal Document . It Is Intended To Serve As An Aid In Graphic Representation Only.