

Revisions

CODE	DATE	CASE	FROM	TO
001	08/07/61			A-1
002	06/07/66	Z66-009	A-1	R-1
003	02/20/68	Z67-041	R-1	O
004	04/21/86	AO1985-253A-1		AURORA
005	04/21/86	AO1985-254A-1		AURORA
006	04/21/86	AO1985-255A-1		AURORA
007	04/21/86	AO1985-256A-1		AURORA
008	09/29/86	AO1985-258RECORDED		AURORA
009	04/25/00	AO1985-102A-1		AURORA
010	07/25/00	AO2000-41	A-1	AURORA
011	02/06/01	CENTENNIAL INCORP.		CENTENNIAL
012	10/09/01	Z00-011	A-1	MU
013	12/10/02	P01-082		FDP
014	08/23/03	AO2003-45	A-1	AURORA
015	12/09/06	AO2006-61	A-1	AURORA

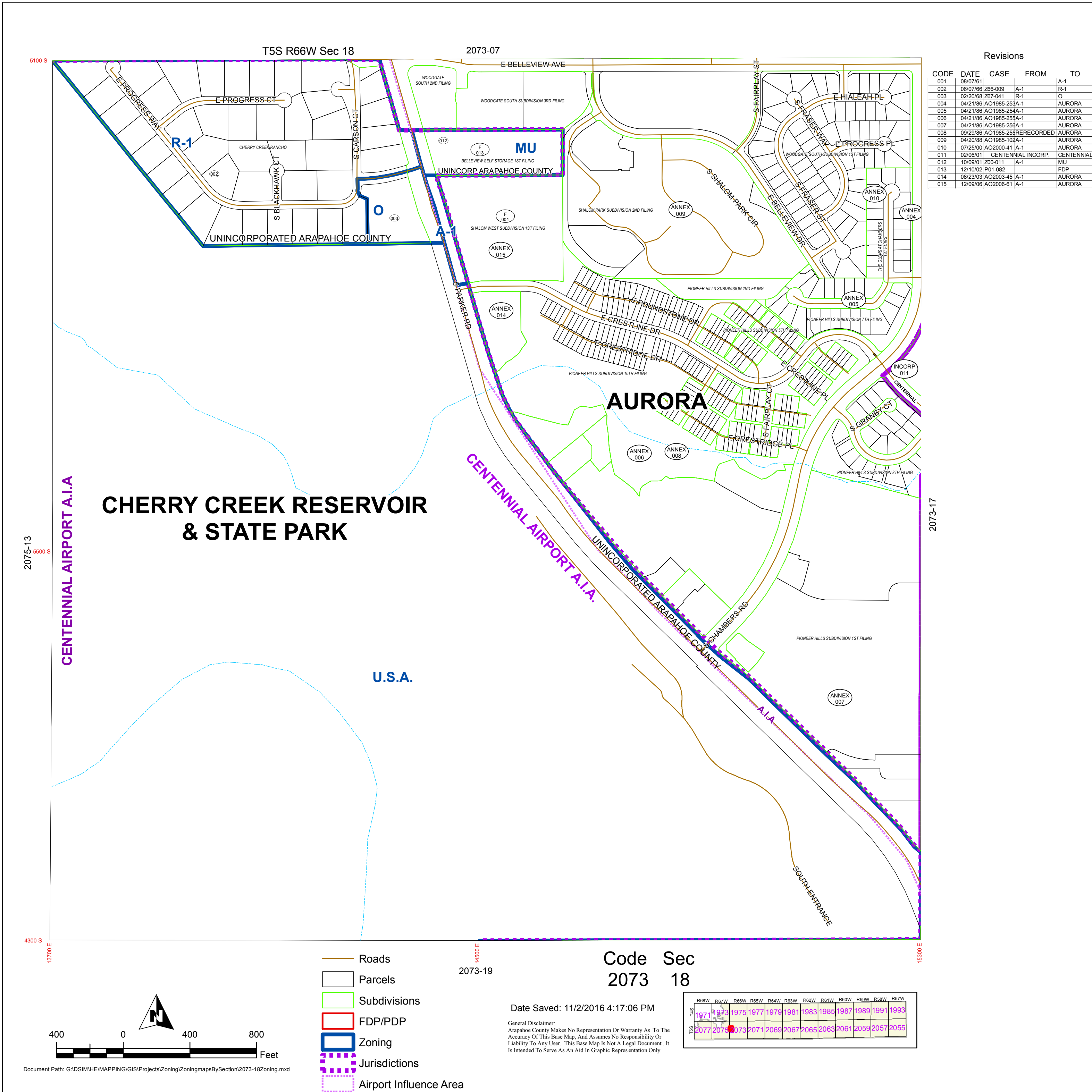

CHERRY CREEK RESERVOIR & STATE PARK

AURORA

U.S.A.

- Roads
- Parcels
- Subdivisions
- FDP/PDP
- Zoning
- Jurisdictions
- Airport Influence Area

Code Sec
2073 18

Date Saved: 11/2/2016 4:17:06 PM
 General Disclaimer:
 Arapahoe County Makes No Representation Or Warranty As To The Accuracy Of This Base Map, And Assumes No Responsibility Or Liability To Any User. This Base Map Is Not A Legal Document. It Is Intended To Serve As An Aid In Graphic Representation Only.

	R68W	R67W	R66W	R65W	R64W	R63W	R62W	R61W	R60W	R59W	R58W	R57W
1971	1973	1975	1977	1979	1981	1983	1985	1987	1989	1991	1993	
2077	2079	2081	2083	2085	2087	2089	2091	2093	2095	2097	2099	

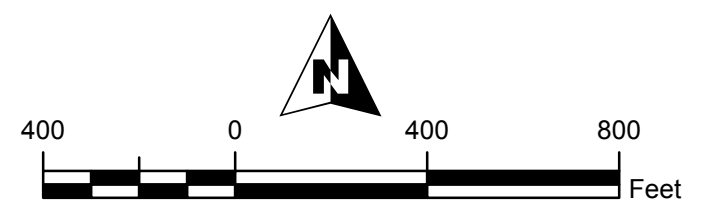

Document Path: G:\DSIM\HE\MAPPING\GIS\Projects\Zoning\ZoningmapsBySection\2073-18Zoning.mxd