

Revisions

CODE	DATE	CASE	FROM	TO
001	08/07/67			A-1
002	11/08/82	282-030	A-1	MU,F
003	04/23/85	A85-010		MU
004	09/10/85	AC1985-88 thru 98	MU	ANNEX
005	11/09/93	L93-005		LE
006	03/07/96	L96-001		LE
007	06/19/01	L01-005		LE
008	10/19/04	Z04-007	MU, F	MU,F
009	11/16/04	Z04-004	MU, F	MU,F
010	11/10/05	TA05-008		PDP-TA
011	03/07/06	P05-014		FDP
012	12/05/06	P06-007		FDP
013	09/10/07	A07-001		FDP
014	03/20/07	Z06-010	MU, F, A-1	MU
015	02/22/11	P10-008		FDP
016	04/18/11	A10-008		FDP
017	06/25/12	L11-006		LE
018	02/12/13	A12-101		FDP
019	07/01/13	A13-001		FDP
020	11/18/13	TA13-003		FDP-TA
021	10/01/13	Z13-003	MU, F	MU, F
022	02/19/14	A13-015		PDP
023	04/22/14	P13-009		FDP
024	05/01/14	P13-011		FDP
025	06/13/14	TA14-005		FDP-TA
026	11/02/15	A15-010		PDP
027	02/02/16	P15-007		FDP
028	02/07/17	A16-012		FDP-AA
029	05/16/17	Z16-009	MU,F	MU,F
030	05/16/17	P16-029		FDP
031	07/11/17	P16-013		FDP
032	03/22/18	A17-014		ASP
033	05/22/18	FDP17-022		FDP
034	06/19/18	FDP18-001		FDP
035	12/11/18	GDP18-002	MU,F	MU,F

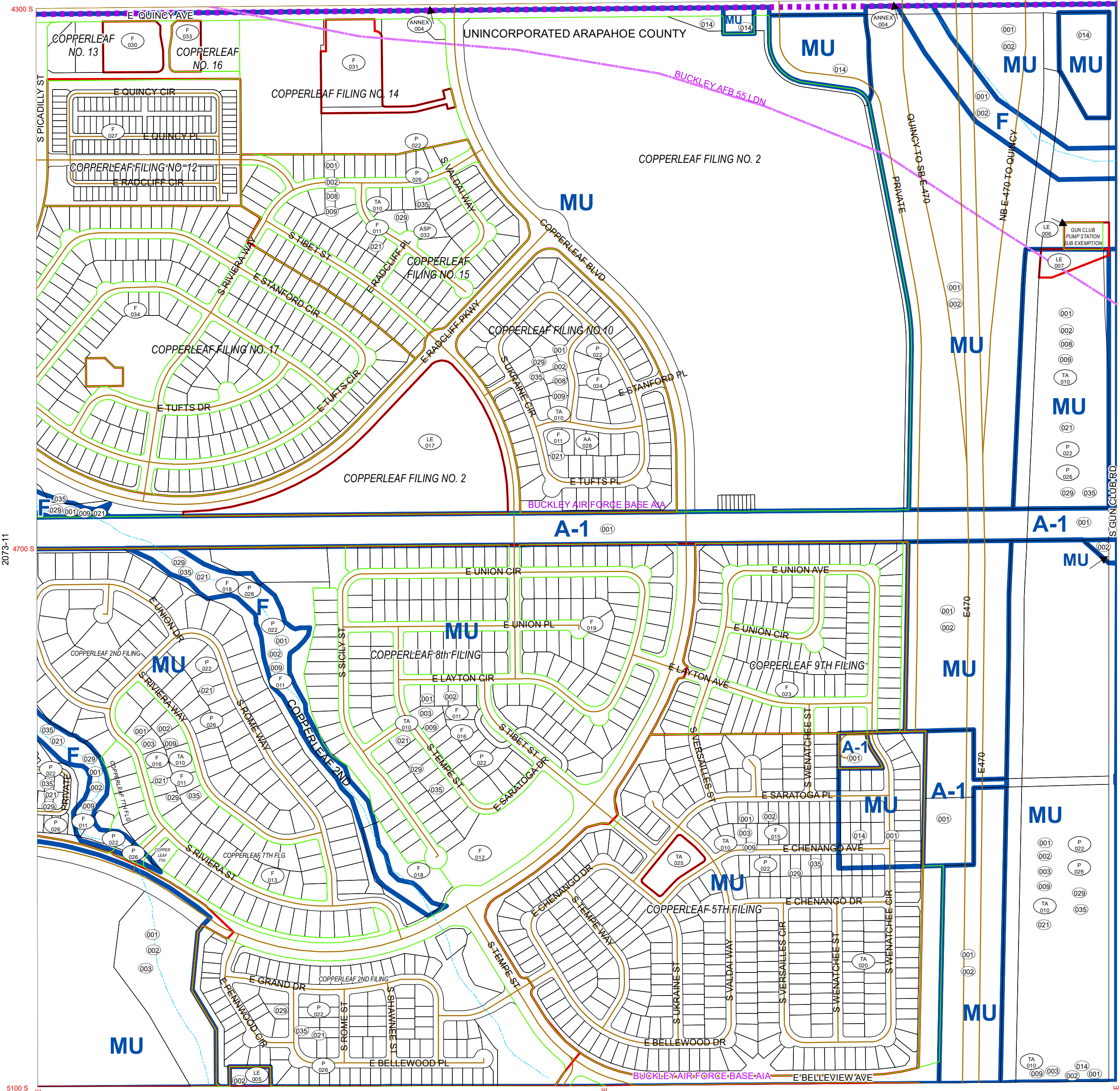

- Roads
- Parcels
- Subdivisions
- Zoning Restrictions
- Zoning
- Jurisdictions
- Airport Influence Area

Code Sec
2073 12

Date Saved: 6/13/2019 3:04:50 PM

General Disclaimer:
Arapahoe County Makes No Representation Or Warranty As To The Accuracy Of This Base Map, And Assumes No Responsibility Or Liability To Any User. This Base Map Is Not A Legal Document. It Is Intended To Serve As An Aid In Graphic Representation Only.

R68W	R67W	R66W	R65W	R64W	R63W	R62W	R61W	R60W	R59W	R58W	R57W	
T5S	1971	1973	1975	1977	1979	1981	1983	1985	1987	1989	1991	1993
T6S	2077	2075	2073	2071	2069	2067	2065	2063	2061	2059	2057	2055

