

ADAMS COUNTY

T4S R66W SEC 02

| Revisions | | | | |
|-----------|----------|-----------|------|--------|
| CODE | DATE | CASE | FROM | TO |
| 001 | 08/07/61 | | A-1 | A-1 |
| 002 | 12/08/69 | Z69-033 | A-1 | R-1 |
| 003 | 12/16/69 | Z69-033 | A-1 | B-5 |
| 004 | 05/26/69 | Z69-015 | A-1 | R-A |
| 005 | 05/22/73 | AO 73-45 | A-1 | AURORA |
| 006 | 03/10/80 | AO 79-164 | A-1 | AURORA |
| 007 | 03/12/91 | AO 90-130 | R-A | AURORA |

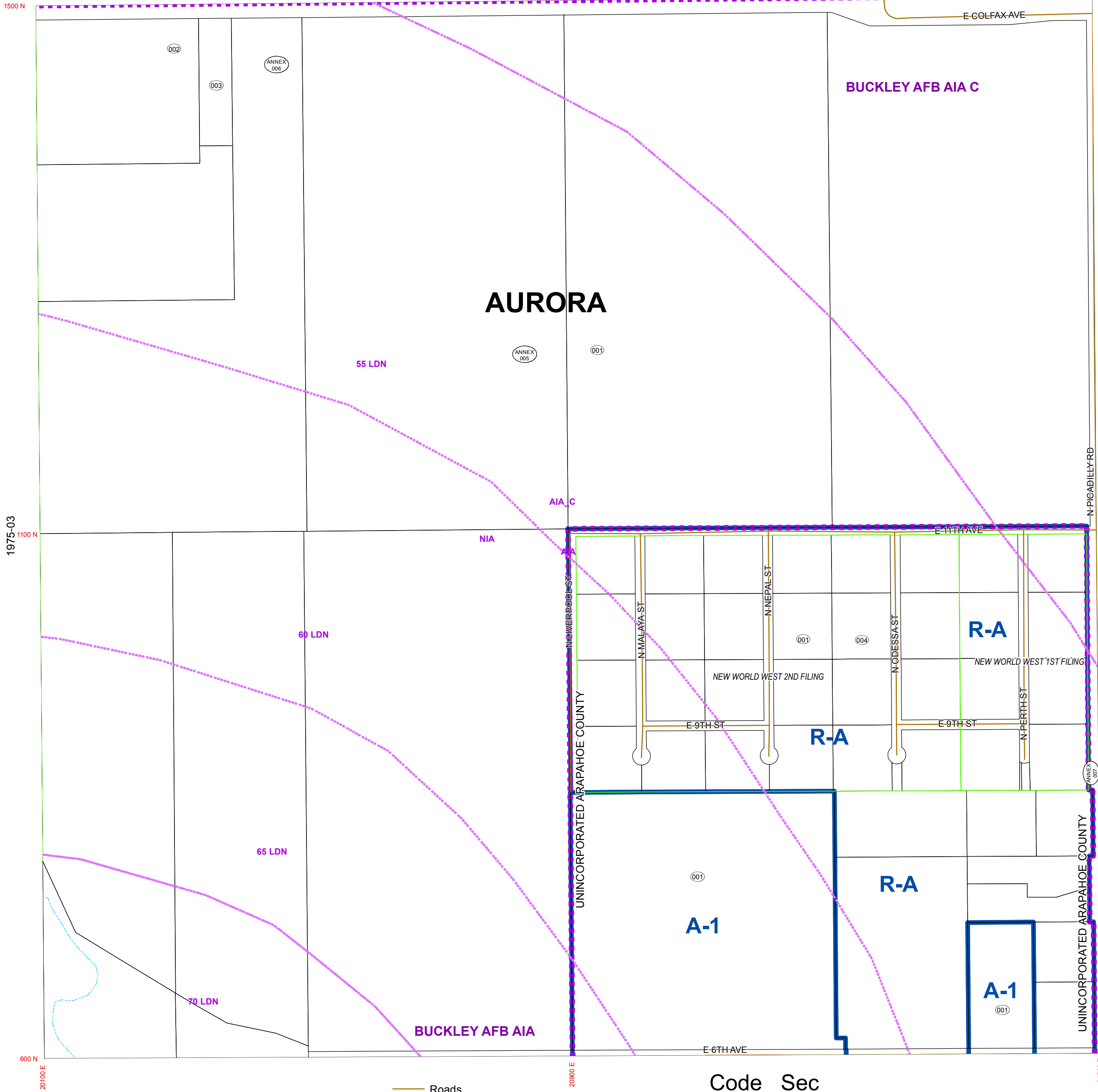

- Roads
- Parcels
- Subdivisions
- FDP/PDP
- Zoning
- Airport Influence Area
- Jurisdictions

Code Sec
1975 02

1975-11

Date Saved: 6/23/2016 11:32:05 AM

General Disclaimer:
Arapahoe County Makes No Representation Or Warranty As To The Accuracy Of This Base Map, And Assumes No Responsibility Or Liability To Any User. This Base Map Is Not A Legal Document. It Is Intended To Serve As An Aid In Graphic Representation Only.

| | | | | | | | | | | | | |
|-----|------|------|------|------|------|------|------|------|------|------|------|------|
| | R68W | R67W | R66W | R65W | R64W | R63W | R62W | R61W | R60W | R59W | R58W | R57W |
| T4S | 1971 | 1973 | 1975 | 1977 | 1979 | 1981 | 1983 | 1985 | 1987 | 1989 | 1991 | 1993 |
| T5S | 2077 | 2075 | 2073 | 2071 | 2069 | 2067 | 2065 | 2063 | 2061 | 2059 | 2057 | 2055 |

